

PHASE 4

(NOVEMBER - DECEMBER 2015)

LEFT TURN FROM BIGELOW BOULEVARD WEST BOUND
ONTO BLESSING STREET IS PROHIBITED (SEE DETOUR PLAN)

DURING PHASE 4, TRUCK RIGHT TURN FROM BLESSING STREET TO
BIGELOW BOULEVARD WILL BE PROHIBITED (SEE DETOUR PLAN)

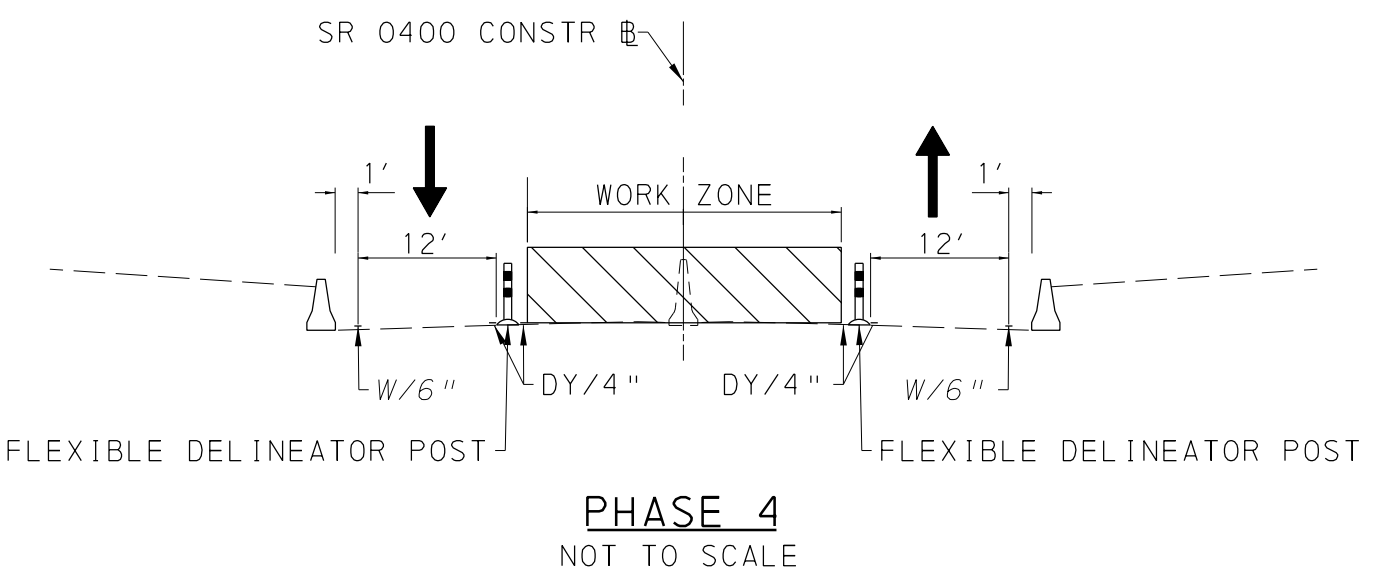
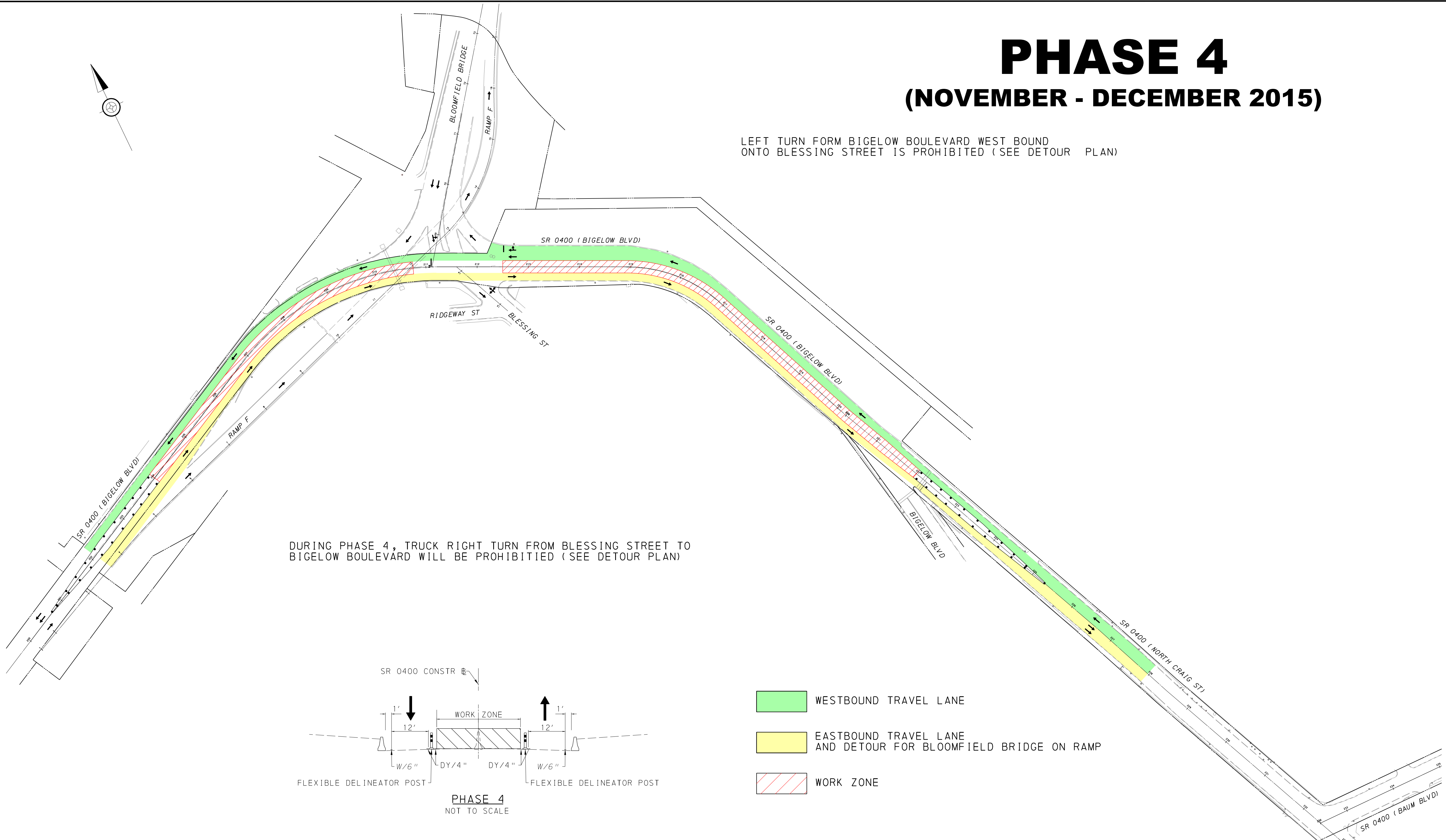

- WESTBOUND TRAVEL LANE
- EASTBOUND TRAVEL LANE
AND DETOUR FOR BLOOMFIELD BRIDGE ON RAMP
- WORK ZONE